

MIP MOT MINI ZERO

Motorised wall mount

Soporte motorizado de pared

Stand a parete motorizzato

Moottoroitu näytön teline seinäkiinnityksellä

Solution murale réglable en hauteur électriquement

Installation manual

Manual de instalación

Manuale di installazione

Manuel d'installation.

Asennusopas

Manuel d'installation



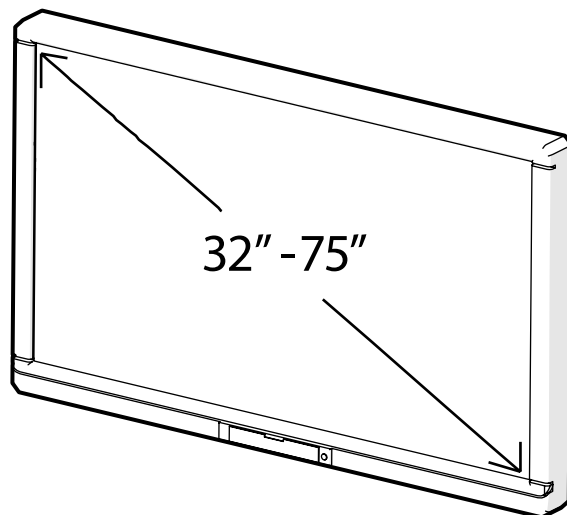
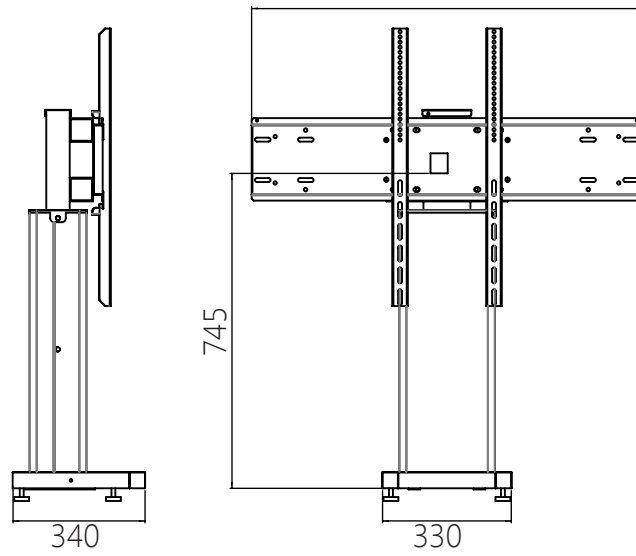
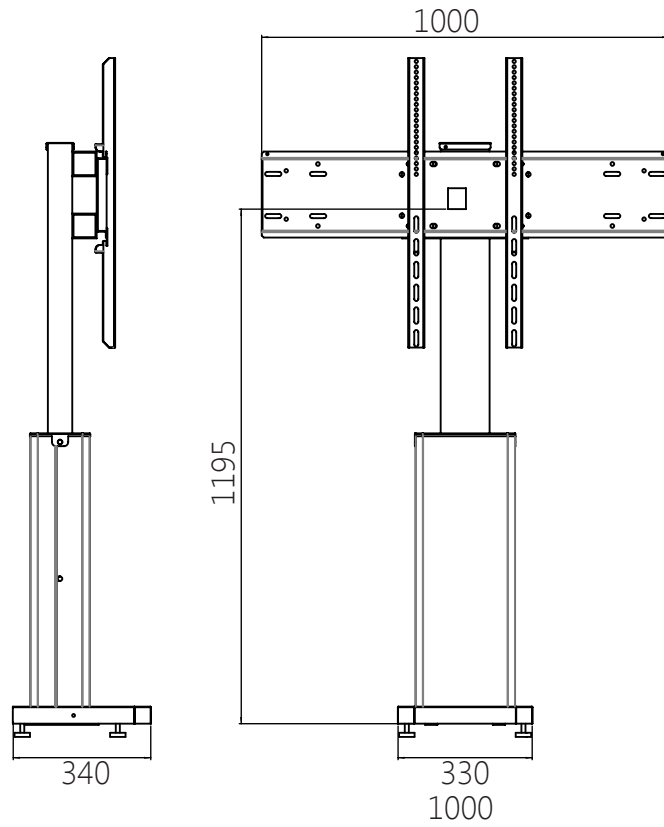

CONTENIDO/CONTENTS/CONTENUTO/SISÄLLYS/CONTENU:

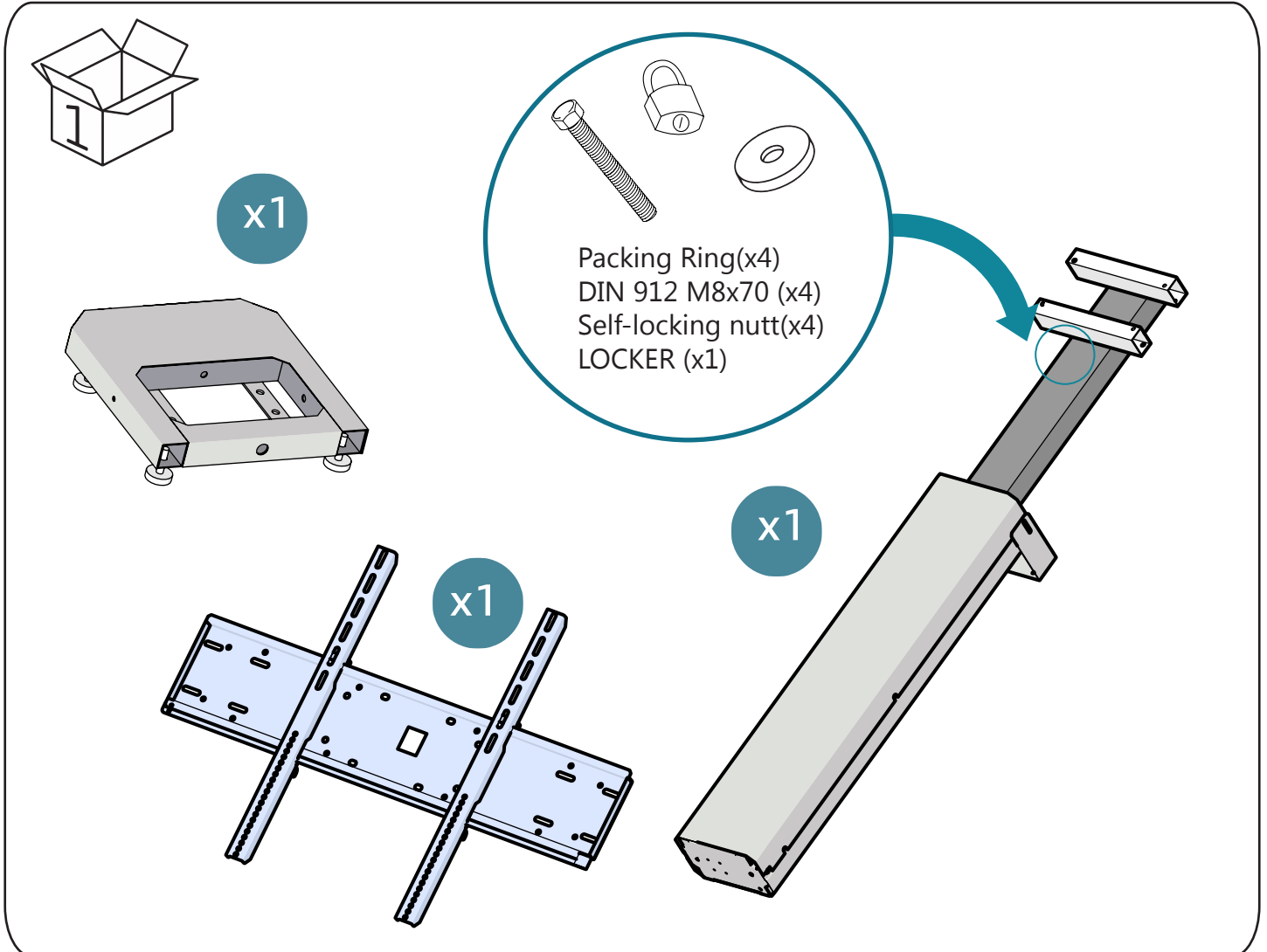

HERRAMIENTAS NECESARIAS/TOOLS NEEDED/ATTREZZI NECESSARI/TARPEELLISET TYÖKALUT/OUTILS NÉCESSAIRES:

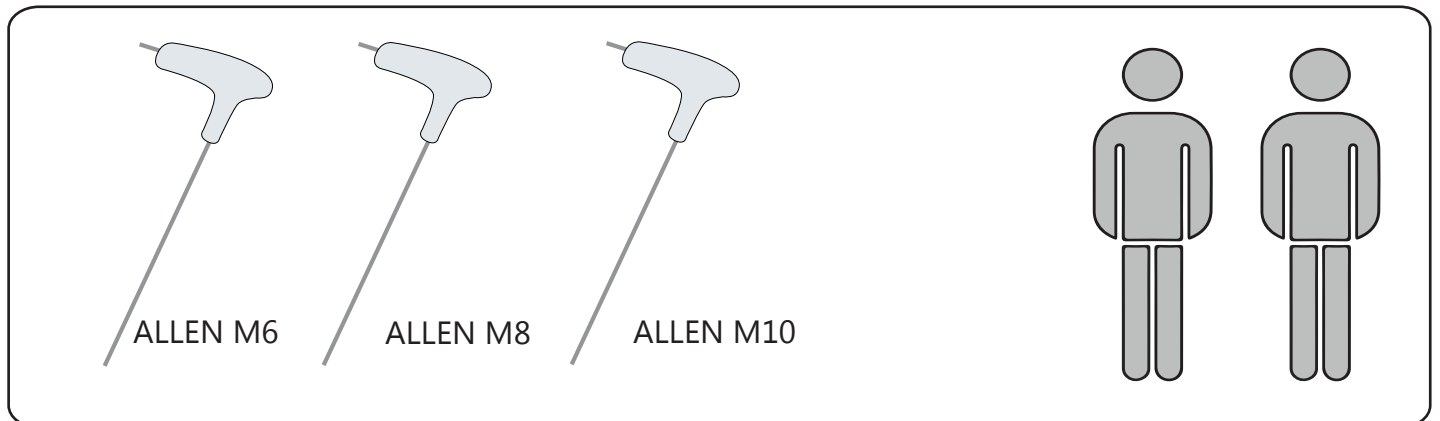

1

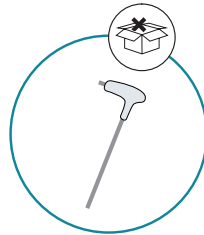
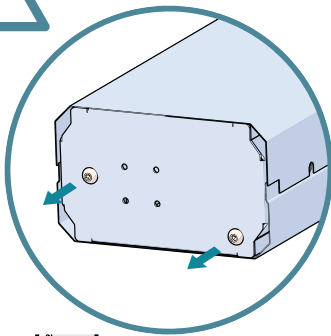

ALLEN M10

2

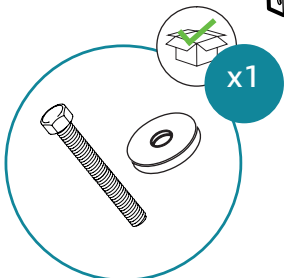

DIN 912 M8x50

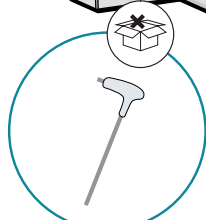

ALLEN M6

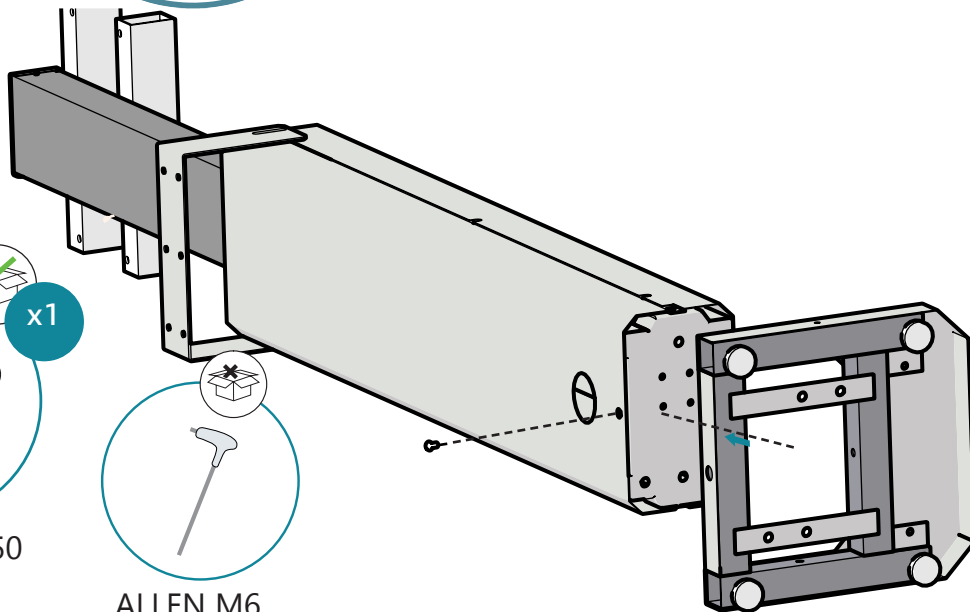

3

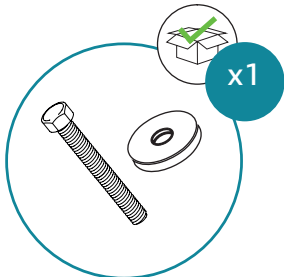

DIN 7380 M10x20

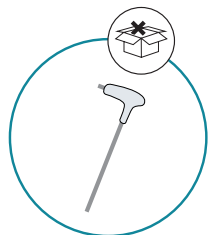

ALLEN M10

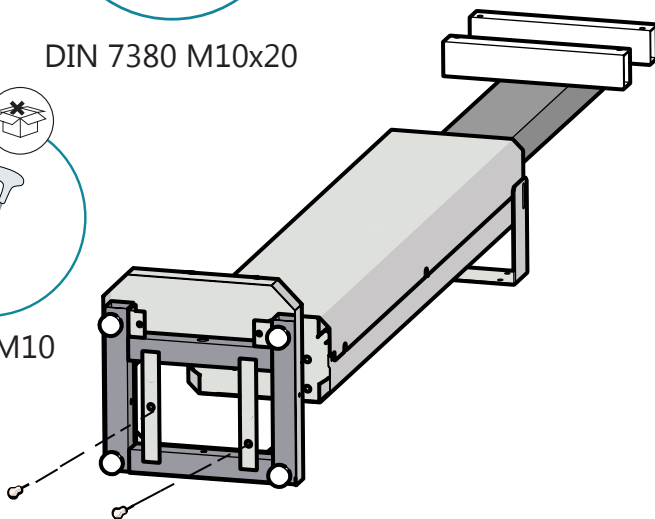

4

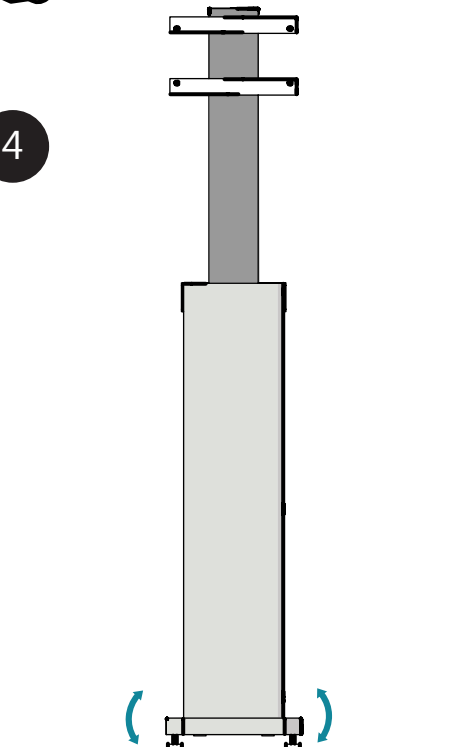

4

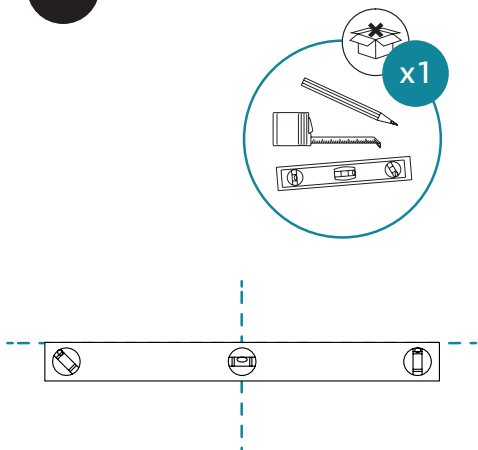

5

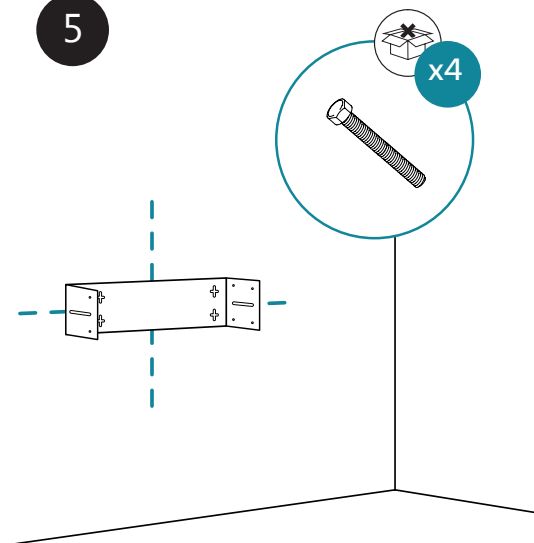

6

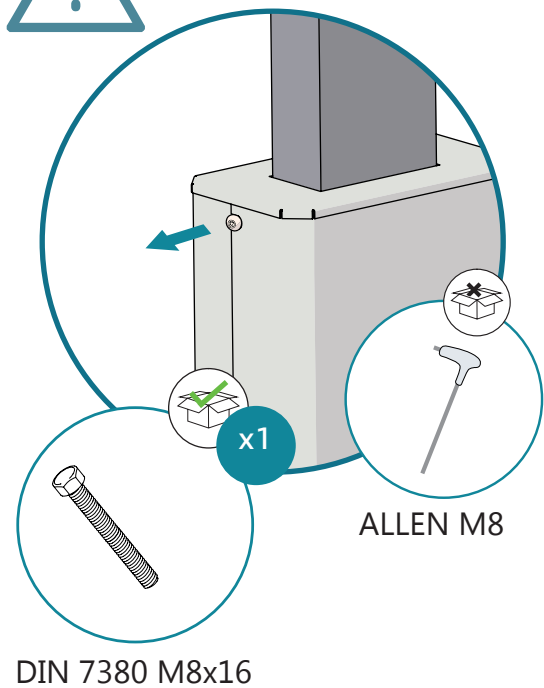

7 Opcional/Optional

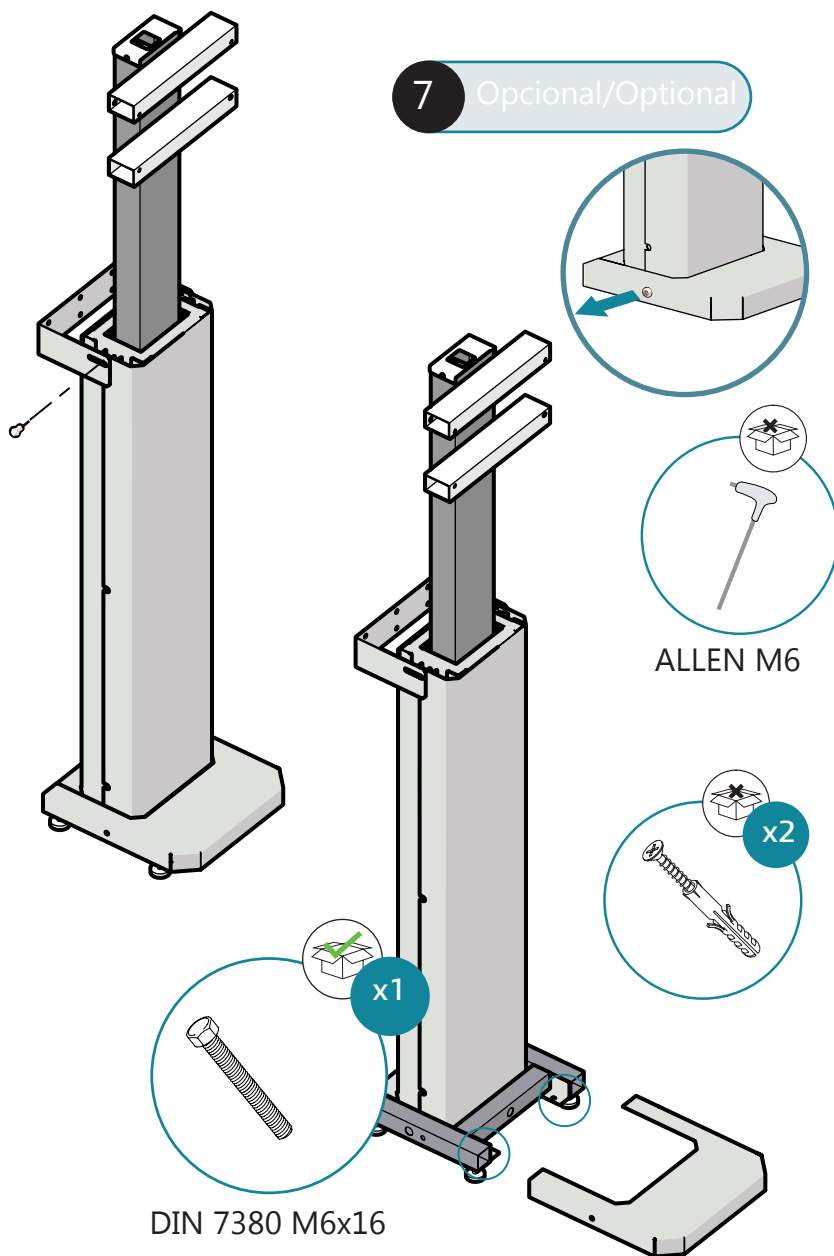

8

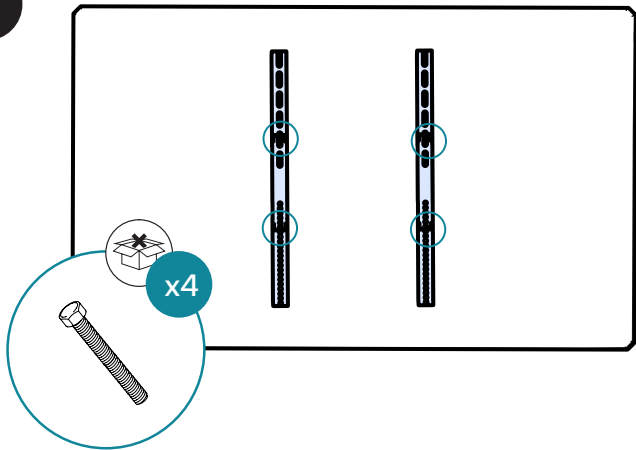

9

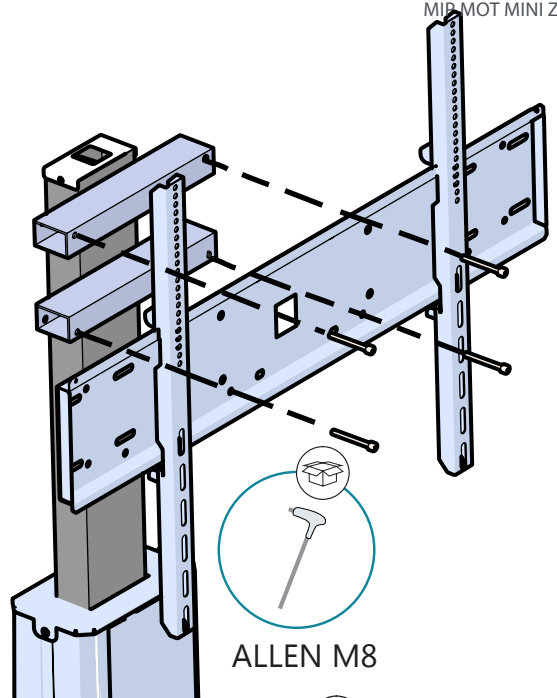

10

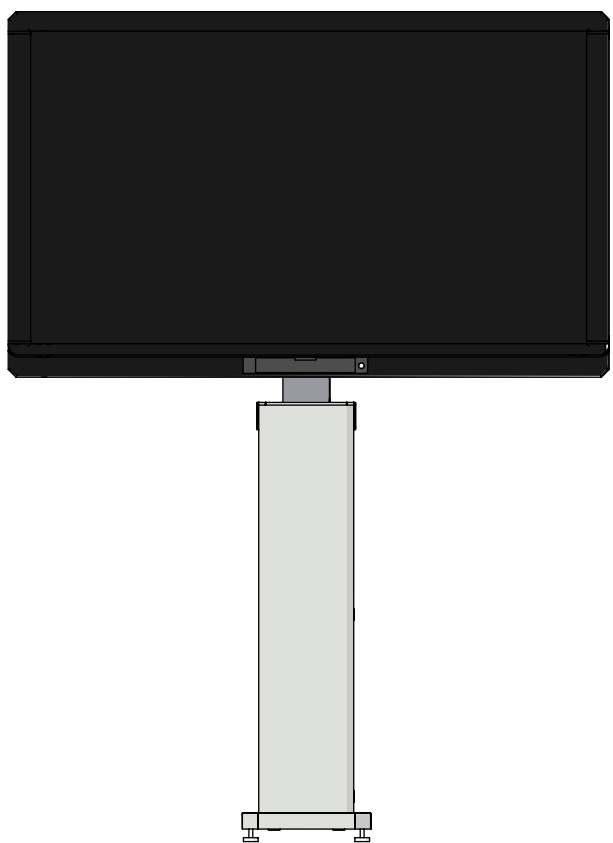

11

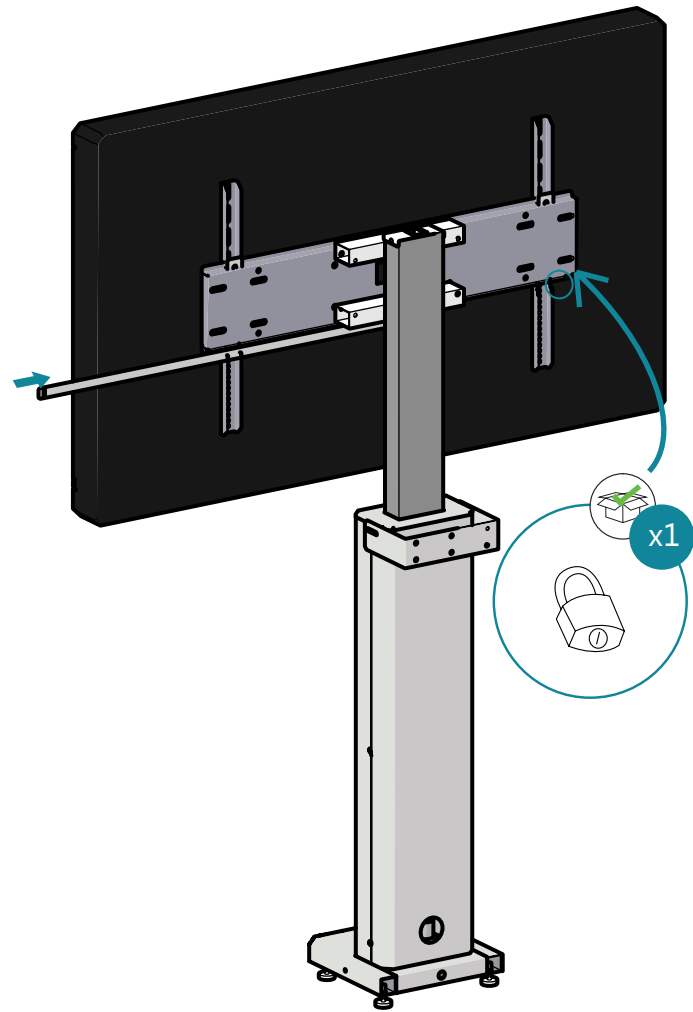

12

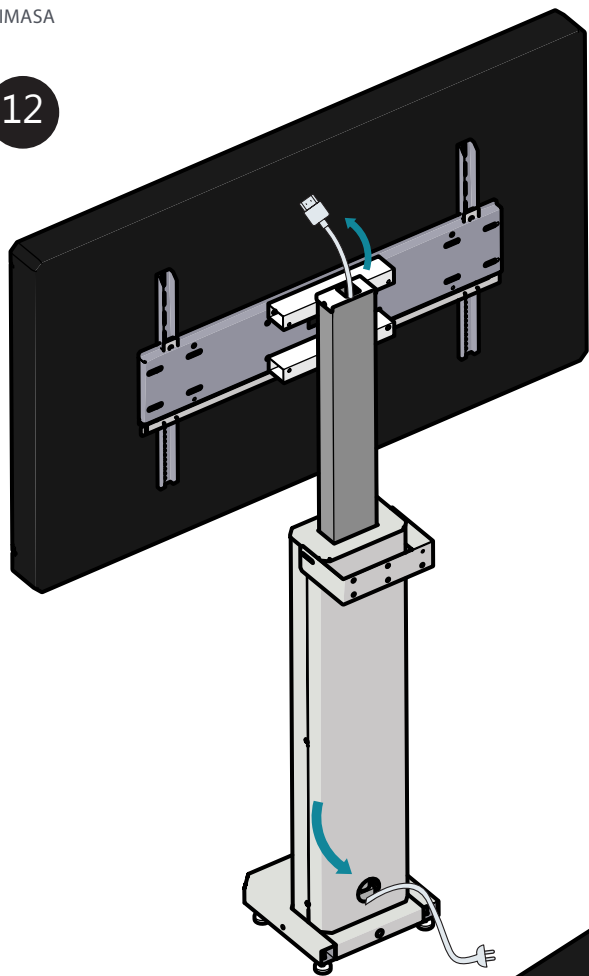

13

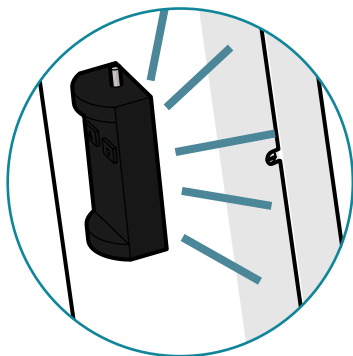
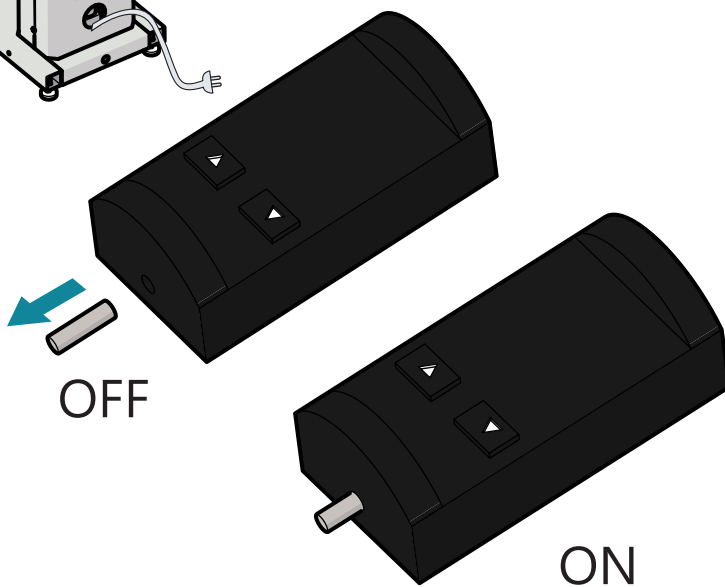
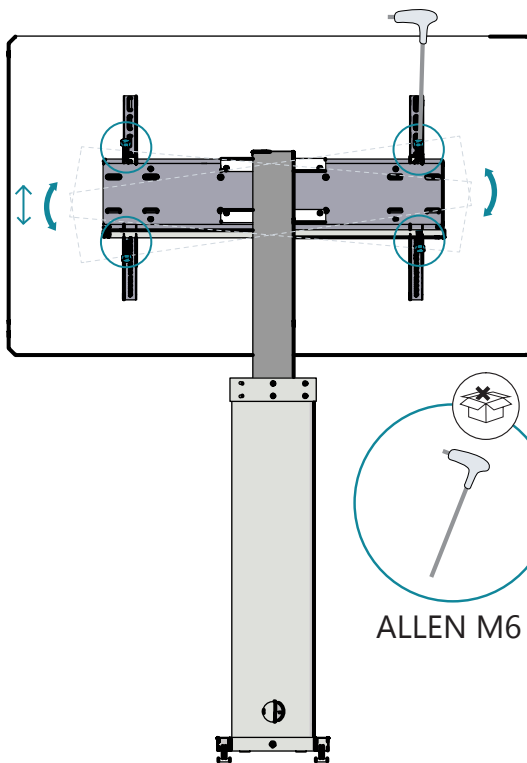

Enganchar el mando a distancia en la columna.
Remote control will magnetically stick to metal column .
Il telecomando si aggancerà magnéticamente alla colonna in metallo.
Kauko-ohjain kiinnittyy automaattisesti metalliseen pylvääseen.
La télécommande sera maintenue magnétiquement sur la colonne.

DIAGRAMA ELÉCTRICO DEL MOTOR / ELECTRICAL DIAGRAM OF THE LIFTING SYSTEM / DIAGRAMMA DELL'IMPIANTO ELETTRICO DI SOLLEVAMENTO / NOSTOJÄRJESTELMÄN TEKNINEN KAAVA / SCHÉMA ÉLÉCTRIQUE DU SYSTÈME DE REHAUSSE.

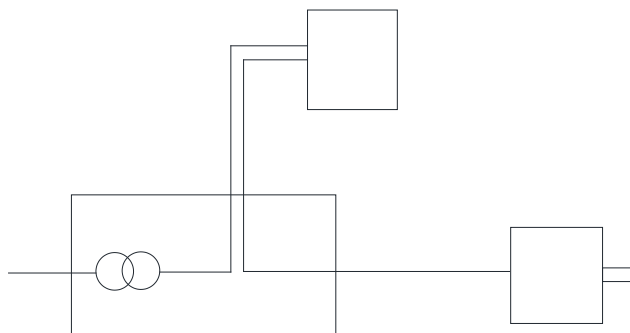

Input: AC 100V-240V, 1.500mA;
50/60Hz
Output: DC29V - 2A

Max. Load: 6.000N; IP44
Power Rating 24 DVC, Max: 2AMP



DIMASA

BARCELONA

C/ Travesera de Gracia nº 66, 1º2ª

08006 Barcelona (Spain) | Tel. +34 93 462 06 04

MADRID

C/ Parque Ferial nº 11 (Pol. Ind. Urtinsa II), 28923

Alcorcón (Madrid, Spain) | Tel. +34 91 616 96 88